

Paths to sustainability

Plan green think blue





wedi on the green path

Sustainability is a huge concept. Within the pages of this brochure we would like to show you what it means for us. wedi's focus is on people and their desire for a future with a high quality of life in an intact environment. We understand sustainability as reconciling the needs and demands of today's people with those of future generations.

Sustainability is something which constantly needs to be worked on. Only when we are successful in combining doing business with protecting people and the natural environment will we achieve sustainable success. As a medium-sized family-run business it is in our own best business interest to be sustainable. However, this does not automatically make us sustainable by any means. When my father founded the company in 1983, he made sustainability one of the cornerstones of the company's philosophy: by providing practical solutions to relevant ideas wedi helps its customers to long-term success. Of course, in doing so, technical experience, understanding of the customer's wishes and accurate assessment of future factors during the building process are essential. Sustainable building is one such important factor that can substantially relieve the burden on the environment through concrete solutions. Energy efficiency and sparing use of resources as well as age-appropriate and barrier-free living are important goals for wedi. We follow these goals consistently and provide everyone involved in the building process with optimised solutions: building contractors, planners, commercial suppliers and tradesmen. The new challenge is to provide such solutions that not only meet our clients' needs but are also in keeping with our responsibility to deliver sustainable solutions that make sense for everyone. We focus on this together with our professional partners. Together with our committed workforce, I am convinced: wedi is going in the right direction.



Regards,
Stephan Wedi



Sustainable building – significance and necessity

Common goals

Let's think outside the box together. Whether it be a private or commercial property, sustainable building combines the interests of all involved under economical, environmental and social aspects. The goal of sustainable building is to fulfil the intention of the building contractor and the needs of the end user to the greatest possible extent while, at the same time, reducing the impact on the environment as much as possible.

The big wheel

In the region of 40 % of greenhouse gas emissions and 30 % of all resources used are related to the buildings sector.

Building with relevant and sustainable solutions is one of the critical factors in order to combat ever decreasing resources in a world with an ever increasing population.



We all spend roughly 90% of our lives in buildings. In order to be sustainably used, these buildings need to be built in such way to meet requirements for which the building was intended for and to allow ease of access for people of all ages.

Decisive questions

Wouldn't it make sense to take not only the building costs but also the running costs of a bathroom over its entire lifetime into consideration? How can the service lives of construction materials be extended? Shouldn't the wellbeing of the installer and every other partner coming in contact with building materials be as much of a concern as the end user's? How can the impact on the environment be minimised during a building process?

wedi develops practical solutions

Sustainable building is an important step. When the goals and needs of the building contractor are defined, planners and tradesmen can begin to realise optimum solutions with their foresight and practical experience. wedi provides its market partners with the right products and valuable support to help them make this happen.

Accountable



People are the focus

Whoever is thinking sustainably has the future of their customers and partners as their focus. wedi is a reliable partner for the people that accompany us each and every day. It is for this reason that wedi actively looks after their long-term success. Our partners' success is a basis for wedi to be successful long into the future.

Achieving sustainability together

Sustainable building more than ever before requires a networked working structure. wedi can offer its market partners all the right reasons to choose wedi as their partner: such as unlimited design possibilities for age-appropriate and compliant usage, practical planning tools, healthfriendly working practices on the building site and unrivalled long-term durability of the materials.

Ideas for better solutions

Commitment and the spirit of innovation are what define our business. These characteristics led to the wedi board becoming the generic term for such components within the construction industry. We help to shape a positive future for our customers' customers as well as developing and expanding markets. We at wedi understand our responsibility as the market leader and we carefully prepare before introducing new developments.

Successful for many reasons

We meet the high expectations of our customers with solutions which take commercial success, environmental sense and social responsibility into equal consideration. The protection of the environment and the world's natural resources is the basis for sustainable business development. wedi justifies the trust clients put in it by being reliable and trustworthy every step of the way.

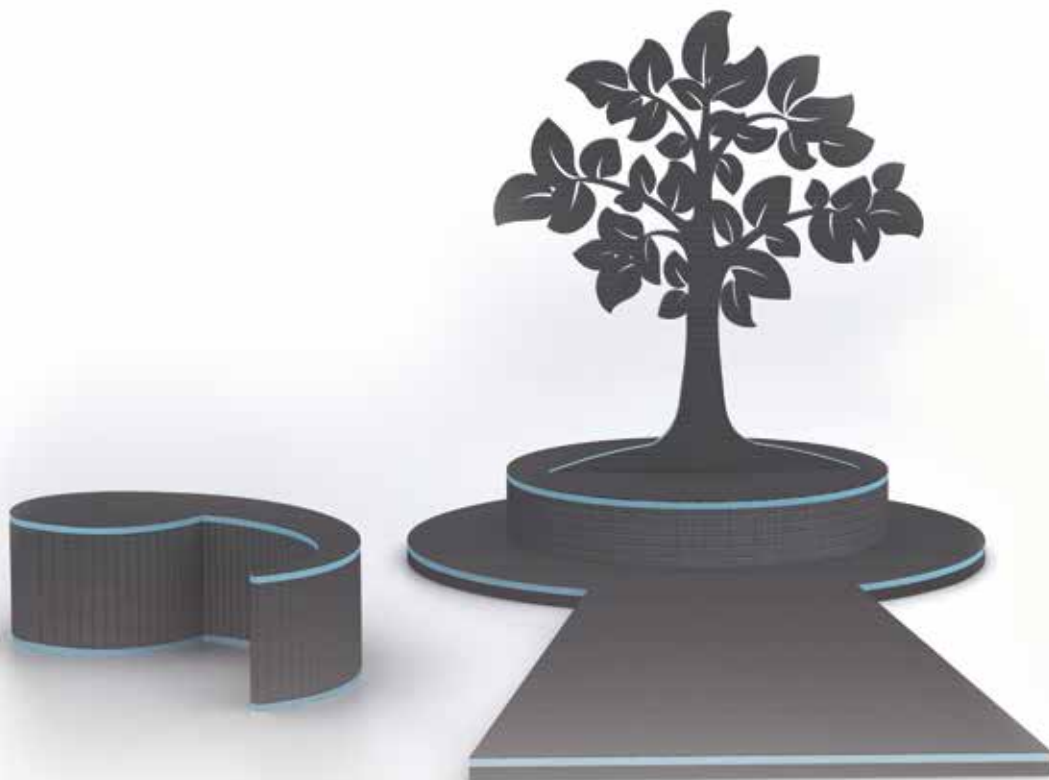



Environmentally friendly

The impact in buildings

Building materials will be present in buildings for decades meaning that the choice of material should be given careful consideration. Environmental Product Declarations show a product's environmental footprint and help planners and builders make an informed and sensible product choice. The components of wedi products, the XPS foam core, the cement coating and the glass fibre reinforcement, already have their own EPDs. In terms of energy aspects, wedi products contribute very positively to a building's insulation from the inside.



Ecology and production

wedi is committed to the environment even during the manufacturing of its products and systems. It has now been many years since wedi stopped using environmentally damaging halogenides as the propellant agent for XPS hard foam, replacing it with an environmentally-friendly alternative. Through the consistent modernisation of the entire machinery and plant as well as the heating and compressor systems, we effectively save energy and constantly improve the CO₂ balance.

We produce part of the power required for internal consumption from the company's own photovoltaic system and combine this with the green electricity from 100 % renewable sources which we have used since 2013. The wedi Logistik vehicle fleet has likewise been renewed. Many older lorries have been scrapped and replaced with new models with a better CO₂ "footprint" and Euro 6 of 1.2 g/kWh.

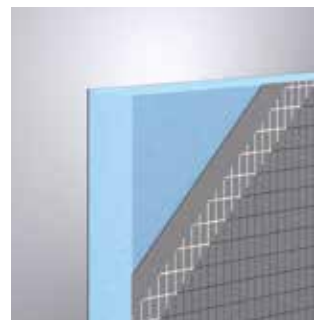

The blue hard foam from wedi contains 25 % of recycled material and with that contributes to the recycling of fossil-based raw materials.

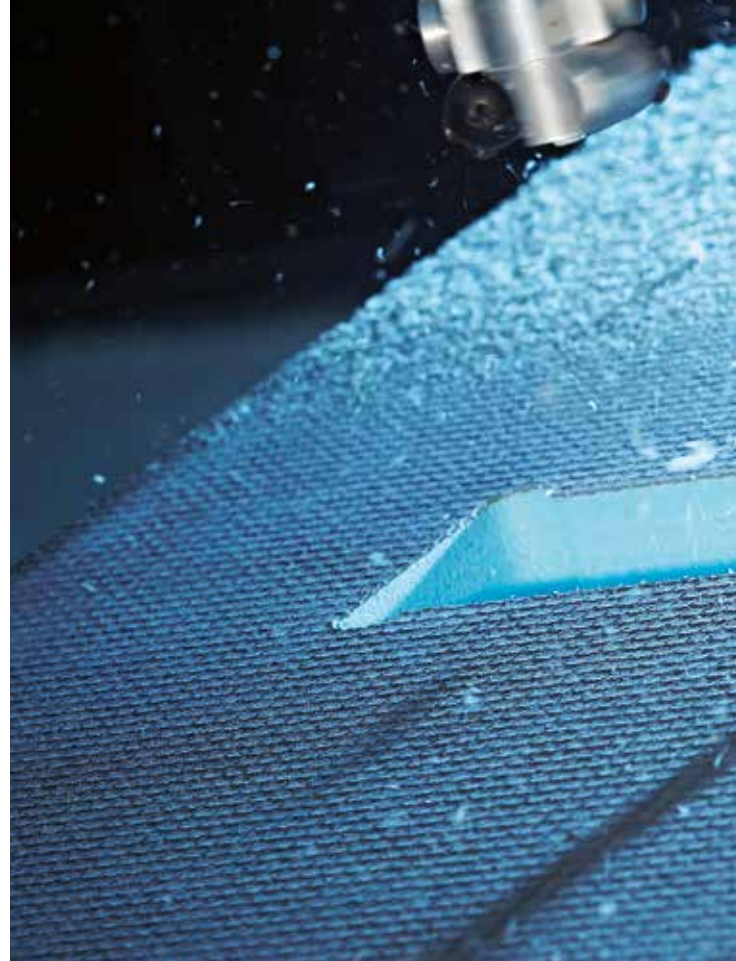

Economically efficient

Sustained success

Lean management has been self-evident for wedi in order for the company to stay competitive. For example, wedi has optimised both its production and logistics processes and our employees played an active role in this. The fundamental idea is to offer innovative products and services which at the same time reduce the burden on the environment. The coherence and management culture of our company is acknowledged and rewarded by our market partners with their trust and loyalty to our brand and by our employees with their outstanding loyalty to our company.

Sustainability long into the future

Success is the result of business foresight. In order for us to be able to respond to foreseeable future shortages of fossil-based raw materials with a commercially viable solution, our research and development team is on a constant look-out for alternative renewable raw materials. We always look at product innovations from a sustainable perspective.

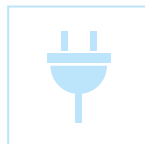

Thanks to numerous energy-saving measures, our energy consumption has remained constant despite increased productivity.



The complete conversion of the lighting scheme in our production facilities not only allowed us to achieve substantial cost savings but also significantly reduced our CO₂-emissions.



Efficient separation of our production waste allows us to transfer materials to new material cycles via certified disposal companies.



With the introduction of our granulation plant in 2016, we have been increasing the recycling rate of our XPS hard foam production waste, and thus, today, our XPS manufacturing process is using 20 – 25% recycled materials.



Socially responsible

wedi integrates – donations, support, wedicef

wedi places a lot of emphasis on the social integration of disadvantaged and unprivileged people in our community. We advocate for people with disabilities and experience shows that they enrich our company with their expertise and strong motivation. We do not lose sight of our employees and community even though success propels us forward.

Since 2001 wedi employees have been encouraging social commitment among the staff. In the past 18 years, numerous activities were 'born' and spread beyond wedi to our customers and partners. For example, mostly in our region, wedi supports a social project benefitting children and young people in every year. wedi is exceptionally proud of the social commitment shown by its employees and pleased about the fitting name of this movement: wedicef.



wedi supports sport,
culture and tradition

wedi is very closely connected to its community and surroundings. We support local sports clubs and associations in their predominantly voluntary work. Cultural projects are also important to us as is the nurturing of valued traditions.

50

wedi currently sponsors 50 different clubs, associations and institutions. Without a doubt, there will be many more to come as we all feel very enthusiastic about this.

So that employees are valued

You can rely on wedi

Growth is the best antidote to employees' worries about their jobs. wedi has been growing continuously for many years internationally and even got around to significantly increase the efficiency of all its processes while doing so.

The high degree of identification that our employees show with the company shows that their needs have never been overlooked during this time.

wedi provides for safety

Safety at work is just as important for us. Each employee receives their own individually adapted safety equipment corresponding to their specific job and the tasks which this entails. We listen to our employees as well: for example as a suggestion from the wedi team, in order to avoid loud and harsh emergency lights on our factory premises, forklifts were furnished with blue safety spots approx. 5 years ago in order to make internal transport safer for all.

8 Years!

A Proud Number.

The current average length of time an employee has been working with us is 8 years – and rising! We have been able, as a growing company with ever growing staffing levels, to keep our staff turnover to a minimum.



wedi motivates

Many career opportunities are open to our employees. Through individual support and on-going training, wedi offers its employees the opportunity to enjoy personal success. The exchange with international subsidiaries also plays an important role in this regard. wedi also rewards ideas more directly on the job: ideas which, for example, help to avoid waste production and increase efficiency. This draws attention to sustainable processes within every department of the company.

wedi cares

wedi of course also offers apprenticeships, trainings and takes steps to secure its own future. wedi accepts its responsibilities as an employer and sets itself the goal to offer full-time employment to all of its apprentices and trainees. Thanks to the flexible practices in place, wedi makes it possible for its employees to combine family and career. A further example of the practical steps taken by wedi to support its employees is the help and advice made available to those employees who need to care for a relative at home.



So that clients feel totally at ease

Sustainability means more than just saving

Of course, when planners and contractors think about sustainable building, the terms energy efficiency, water consumption, heating-cost reductions or reduced environmental burden are what jump to mind. These are important topics obviously, but they don't exactly contain very much living feeling or quality-of-life aspects. Bathrooms for life and barrier-free living are just as important for wedi as the conservation of our resources or the continuous optimisation of our manufacturing process.

wedi helps to prevent mould

Crucial to this is the absolute watertightness and structural stability of the wedi products. This ensures that no water soaks into the substructure which could otherwise provide a fertile breeding ground for mould and fungi. The perfectly finished surfaces of wedi products make it far easier to maintain high hygienic standards. These are particularly important factors to be considered in public buildings and amenities as well as in hotels.

wedi lasts for decades

Bathrooms with timeless design and quality excellence ensure that materials are used throughout the life of the building. wedi substructures provide the fundamental basic requirements and also create enduring value as a result. When it comes to floor-level shower systems, wedi is the market leader in offering the highest flexibility when designing individual and barrier-free bathrooms.

wedi is flexible like life itself

Even with the most farsighted planning, the unexpected can happen. The versatility and customisable nature of wedi products allows for subsequent changes with little effort.

The wedi building board allows new partitions, wash basins and shelf systems to be easily installed thus enrich wet room and bathroom areas with practical and stylish solutions.



The blue wedi XPS hard foam core meets all the highest European standards for air quality. This allows clients to specify wedi products without the danger of polluting the indoor air in any way.

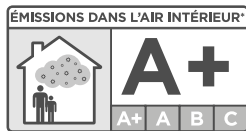

The CE mark demonstrates that the wedi products have been tested and certified as sealing system for wet rooms. The Deutsches Institut für Bautechnik (German Institute for Construction Technology) confirms that wedi building board/Fundo sealing system fully and completely meets the requirements set out in the EU directives.

 0799 (System 2+)
wedi GmbH Hallefeldstraße 51 48282 Emsdetten 13 0799-CPR-132 DuP 0001
ETA-13/0385 ETAG 022 Teil 3
<small>Bausatz mit wasserdichten Platten und weiteren Komponenten zur Herstellung einer Abdichtung und einer Nuttschicht für die Verwendung in innen liegenden Nassbereichen Klassifizierung des Systems und deklarierte Produkt- und Systemeigenschaften siehe Anhang 1 der ETA-13/0385</small>



So that installers can perform better

wedi convinces, wedi excites

wedi has had a close business relationship with its tradesmen partners for over 30 years now. The joint success is the convincing solution for the building contractor that continues to pay off in the long term. The precision engineered surfaces of wedi products and their customisable nature allows for tailored solutions in the hands of a skilled tradesman. Whoever builds with wedi will delight customers! This is because with wedi products the only limit is the imagination: baths, showers, wet rooms to fall in love with thanks to their timeless design and superior quality. A bathroom for life that you just cannot part with has sustainability written all over it.

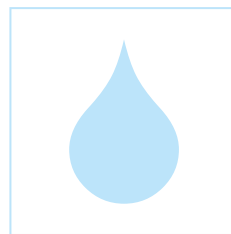
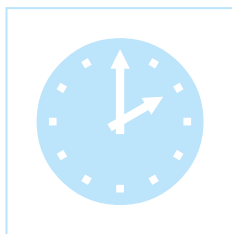

wedi saves time and travel

What good are the most „sustainable“ products if they don't stand the test when it comes to the calculations? They're not even actually sustainable at all because they are never actually used! wedi products can't be beaten when it comes to how easy they are to work with and use. They are light, easy to install and can be ready to reuse again in a very short amount of time. That saves time and travel. They can be flexibly adapted and adjusted on site and when used correctly, do not lose any of their functionality or their guarantee. Positive factors even from a calculative point of view.

wedi doesn't take things lightly

The health of those working with our products is important to us here at wedi! wedi products mean no tiring hauling to upper floors. No lifting and working on heavy planks at heights. wedi products are light and easy on your back. In addition to their weight advantages, wedi products also produce very little dust when worked on, thus wedi contributes to a healthier and safer working environment that is good for the wedi partner on the building site and with that an important success factor for the tradesman and his business.

wedi quality is a certainty

100 % waterproof – that's wedi quality. The blue wedi XPS rigid foam remains absolutely waterproof even with a damaged surface and permanently protects against moisture and mould growth behind the wall. Possible complaints and unnecessary rectifications are thus avoided from the beginning. This means: more peace of mind and simply a good feeling – for clients, installers and architects equally.

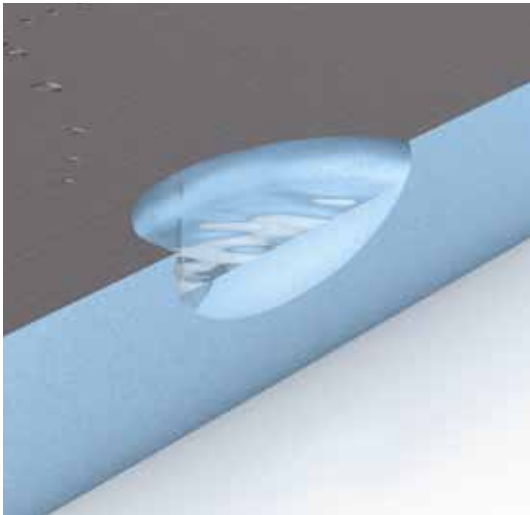

So that retailers can sell with confidence

No experiments

wedi solutions pass the practical test day in and day out. They have become a synonym for the utmost quality and standards and this can be documented with corresponding test certificates from construction supervisory authorities, the test seal for air quality or credible data on renovations carried out with wedi systems resulting in greater energy efficiency. wedi is the quintessential solution for building contractors that are not willing to accept just average, but who also do not like experiments. The most stringent quality standards guarantee structural stability and dimensional accuracy. Perfect solutions with the most sought after properties and quality assurance to meet even the most rigorous requirements.

The CE mark logo, consisting of the letters 'C' and 'E' in a stylized, bold font.

Thanks to the harmonisation of European testing guidelines introduced on 1.9.2013, wedi products can carry the CE mark.



Everyone can build more sustainably

wedi offers feasible solutions for everyone. The reason behind is that we believe that sustainable progress is not derived from elite projects where the cost is no factor but from everyday run-of-the-mill projects fulfilling the wishes of as many people as possible providing them with a 'bathroom for life' that they cannot part with.

Still good arguments today

When it comes to reliability, on-time delivery and consistent quality, you need look no further than wedi. wedi delivers fast thanks to its optimised production processes at a single production location and its highly intelligent and efficient logistics. Our prominent market position and strong international partners guarantee our customers the same high quality at all times and guarantee that practically all product returns can be avoided.

Good when someone knows what they're talking about

The market rewards a great idea over the longterm. However, this happened rather short term with the Fundo Plano. This is because, even today, the flattest solution for floor-level showers is a classic, guarantees success in your product range. Was it luck? We call it being close to and knowing your market as well as correct estimation of opportunities in old and new buildings. Our partners can all rely on our foresight at all times.



100 %

All bespoke/customised building solutions are tested/built in the wedi factory before dispatch and all components marked to aid a quick and efficient assembly. This is to check functionality and to avoid any discrepancies, eliminating the chance of delays on the building site, thus ensuring peace of mind for all involved.

So that planners have the full range of options

Unlimited design freedom

The level of expectation on spa facilities and relaxation areas continues to grow all the time. Planners combine innovative functionality with a touch of extravagance and put their trust in the professional products and support from wedi. wedi is involved in the process from the very beginning; from the idea, to planning the details and all the way through to the realisation and completion.

This opens up brand new possibilities in relation to the design and selection of materials which captivate and excite with their functionality and durability over the entire lifetime of the building.

The bottom line: economic

wedi combines many aspects of sustainable building such as the most limited VOC emission levels in internal areas, very limited cleaning and care requirements for the surfaces with the use of chemical agents being kept to an absolute minimum, safety without tripping hazards and of course energy efficiency thanks to effective heat insulation. Hence the use of wedi systems results in significant reduction of running costs whilst also drastically reducing the amount of time needed for the project as well as the calculated costs through perfect handling.





Energy related renovation in older buildings

Sustainable renovation starts in the wet room because of various energy saving opportunities that can be realised there. For example heating and hot water solutions can often be combined and insulation also plays a decisive role. The special possibilities offered by the wedi energy concept give people a greater quality of life through eco-friendly solutions and at the same time relieve the impact on the environment through saving of resources – all this without the need for expensive and time-consuming renovation work.

A convincing example

The installation of wedi building boards (20 mm) on the external walls of the bathroom (plaster/sand-lime brick) reduce the transmission heat losses by as much as 50 % and as a result reduce heating costs.

You can find more information on this topic at www.wedi.eu. or you can also simply follow the QR code.





Responsibility to people and the environment

Certified environmental management system in accordance with ISO 14001

Environmental responsibility is actively practised at wedi. From the procurement of the raw materials through development and production to sales and the in-house wedi logistics – wedi is committed to complying with all relevant environmental provisions and continuously improving all processes with regard to sustainability and conservation of resources. Coordination of and compliance with the strict guidelines is done through the company-wide environmental management system.

The effectiveness of the holistic wedi environmental management system is attested to here by the independent certification body GUTcert: wedi was certified in accordance with the internationally recognised environmental standard ISO 14001 in 2019. Here, compliance with the standards is not only reviewed annually, it is also continuously managed and monitored by appropriate officers in the company. The wedi products and processes should thus also support customers, partners and suppliers with the sustainable handling of energy and environmental resources.



Certified energy management in accordance with ISO 50001

The wedi ISO 50001 energy management system was recertified in 2018. We thus commit ourselves to the efficient and sustainable handling of energy and resources. The certification, valid for both wedi and wedi Logistik, demonstrates the compliance of our energy management system to our business partners and customers alike.

Nomination as an EcoProfit operation

wedi has been certified as an EcoProfit operation since 2007. Companies which are particularly committed to preservation of the environment and which work in an ecologically sustainable manner are classified with the coveted award. Key topics here are the reduction of energy and water use, as well as the reduction of waste and improvement of material efficiency. wedi is very active within the EcoProfit network and is also a member of the Steinfurt energy-efficiency network. Collaboration and ongoing exchange with other companies is important in order to drive ecological ideas locally, regionally and across Germany.





UL Environmental runs the EPD programme and helps manufacturers which demonstrate compliance with the regulations to improve sustainability and to create transparency with regard to quality and performance. More information can be found at www.deu.ul.com.

Building sustainably. EPD certified.

The need for sustainable construction solutions also increases the demand for environmental product declarations (EPD). The sustainability and the quality of buildings ultimately depends on the components used and their installation situation. The environmental product declaration provides exact quantitative information about the energy and resource use of a product throughout its life span, from production through to final disposal, and is internationally recognised. Only in this way, using the data can architects, planners and clients evaluate the environmental footprint of the building. Furthermore, this data is an important cornerstone of the building certification systems for DGNB, BNB, BREEM, LEED. Anyone who is interested can get an overview of the environmental footprint values and product-related environmental effects using the publicly accessible EPD.

For wedi, there is an EPD for the wedi building boards and for the wedi Fundo shower elements – issued by the Institut für Bauen und Umwelt (Institute for Construction and the Environment). Since product-specific environmental declarations are objectively more valuable than industry-specific environmental declarations, the EPDs offer wedi customers a significantly better decision-making basis. From the data and documentation, wedi customers know exactly what the products contain and what environmental performance they offer. Material properties, e.g. insulation or sound insulation values or the effect on air quality, are also clearly documented.

The EPDs are not only required for the Germany-wide German Sustainable Building Council [DGNB] certification, they are also promoted as an internationally recognised information format and a cross-sector industry standard. The positive environmental footprint of the wedi building boards and wedi Fundo shower elements is thus also verifiably documented for global use. The EPD is valid for a period of 5 years.



- Australia
- Austria
- Belgium
- Bosnia Herzegovina
- Canada
- Croatia
- Czech Republic

- Denmark
- Estonia
- Finland
- France
- Germany
- Great Britain
- Greece

- Hungary
- Iceland
- Ireland
- Italy
- Latvia
- Lithuania
- Luxembourg

- Netherlands
- Norway
- Poland
- Portugal
- Romania
- Russia
- Serbia

- Slovenia
- Spain
- Sweden
- Switzerland
- Turkey
- Ukraine
- USA



wedi GmbH
 Hollefeldstraße 51
 48282 Emsdetten
 Germany

Telephone +49 25 72 156-0
 Fax +49 25 72 156-133

info@wedi.de
 www.wedi.eu

